

LEGEND

PROPOSED TRANSITWAY	
PROPOSED STATIONS	
PROPOSED ROADWAY IMPROVEMENTS	
PROPOSED ROADWAY RESURFACING	
PROPOSED SHARED USE PATH	
PROPOSED SIDEWALK	
PROPOSED STRUCTURES	
PROPOSED SWM FACILITIES	
EXISTING PAVEMENT TO BE REMOVED	
LIMIT OF DISTURBANCE	
TEMPORARY CONSTRUCTION EASEMENT	
PROPOSED DEVELOPMENT BY OTHERS	
EXISTING PROPERTY LINES	
EXISTING WATERS OF THE U.S.	
EXISTING WETLANDS	
PARKS	
FORESTLAND	

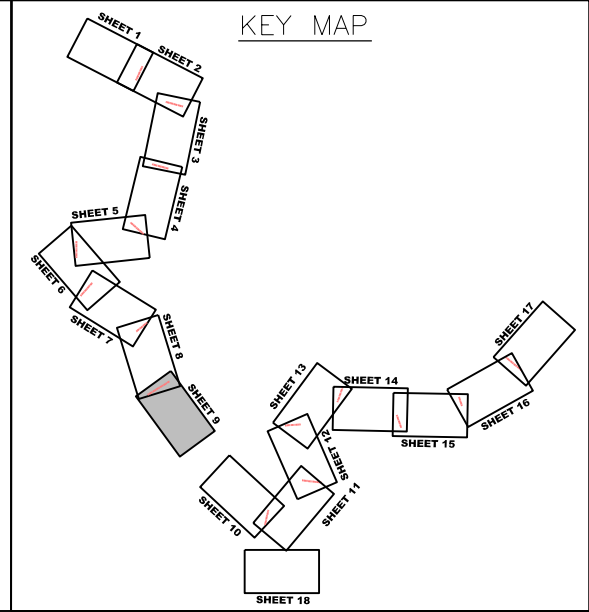

The CCT Study information shown shall be used for general planning information only. The locations of the proposed transit facilities and/or roadway improvements are approximate and subject to change during subsequent stages of project development.

 MARYLAND DEPARTMENT OF TRANSPORTATION MARYLAND TRANSIT ADMINISTRATION	 Corridor Cities Transitway	CORRIDOR CITIES TRANSITWAY ENVIRONMENTAL ASSESSMENT	APPENDIX D SHEET NO. 9 of 18
		STA 483+50 TO STA 605+00 DATE: APRIL 2017 SCALE: 1"=100'	

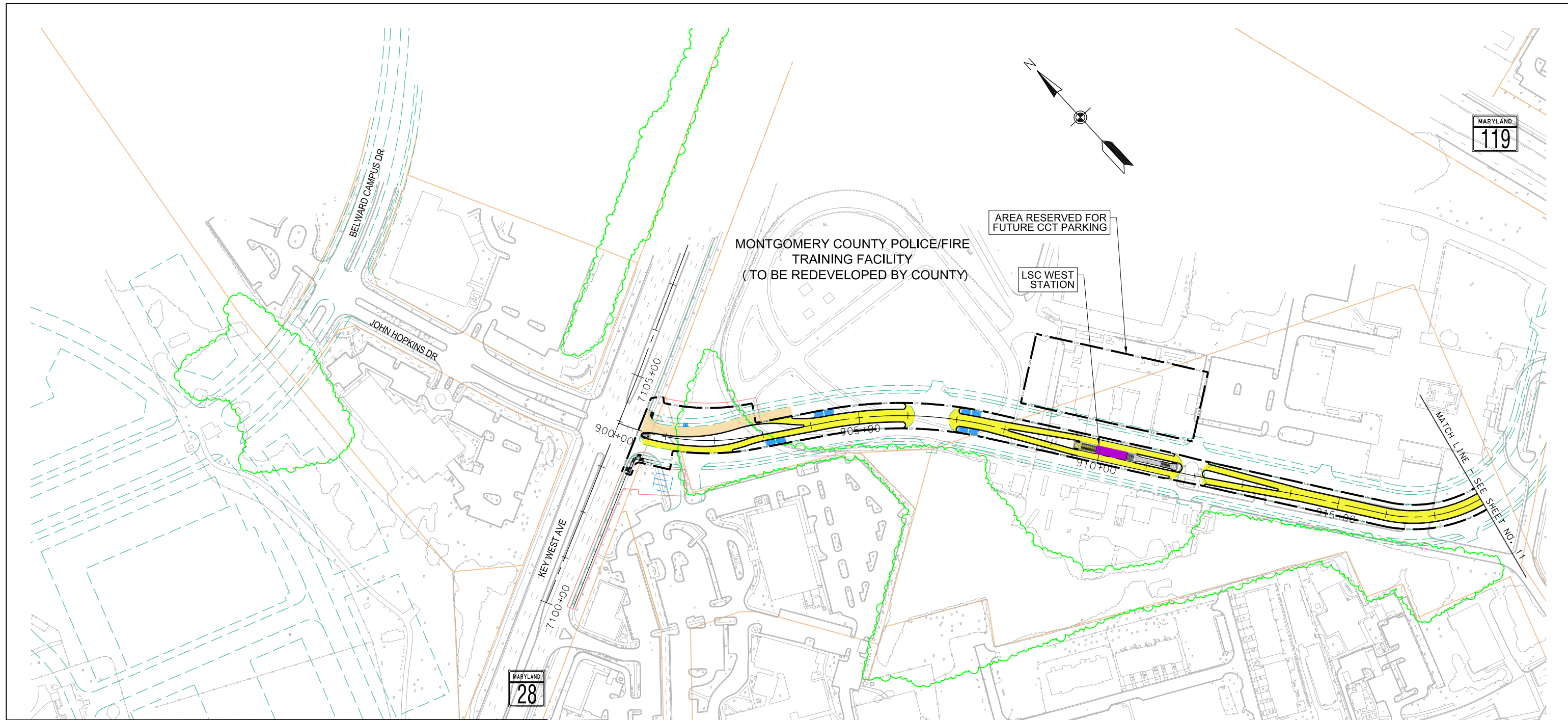

LEGEND

PROPOSED TRANSITWAY	
PROPOSED STATIONS	
PROPOSED ROADWAY IMPROVEMENTS	
PROPOSED ROADWAY RESURFACING	
PROPOSED SHARED USE PATH	
PROPOSED SIDEWALK	
PROPOSED STRUCTURES	
PROPOSED SWM FACILITIES	
EXISTING PAVEMENT TO BE REMOVED	
LIMIT OF DISTURBANCE	
TEMPORARY CONSTRUCTION EASEMENT	
PROPOSED DEVELOPMENT BY OTHERS	
EXISTING PROPERTY LINES	
EXISTING WATERS OF THE U.S.	
EXISTING WETLANDS	
PARKS	
FORESTLAND	

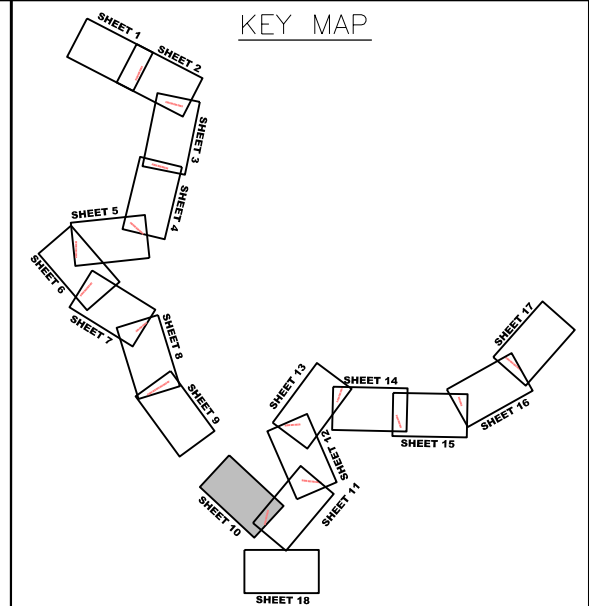

MONTGOMERY COUNTY POLICE/FIRE TRAINING FACILITY (TO BE REDEVELOPED BY COUNTY)

LSC WEST STATION

AREA RESERVED FOR FUTURE CCT PARKING

MATCH LINE - SEE SHEET NO. 11

KEY WEST AVE

DARNSTOWN RD

MARYLAND 28

MARYLAND 119

SCALE: 1" = 200'

The CCT Study information shown shall be used for general planning information only. The locations of the proposed transit facilities and/or roadway improvements are approximate and subject to change during subsequent stages of project development.

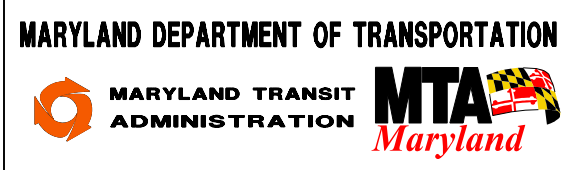

CORRIDOR CITIES TRANSITWAY ENVIRONMENTAL ASSESSMENT

APPENDIX D SHEET NO. 10 of 18

STA 900+00 TO STA 918+00

DATE: APRIL 2017 SCALE: 1" = 100'